



TEJORI
HEIGHTS
KARACHI

PAYMENT SCHEDULE



5 ROOMS TYPE-A	1 st to 4 th	5 th to 9 th	10 th to 13 th
PARTICULARS	AMOUNT	AMOUNT	AMOUNT
ON BOOKING	1,000,000	1,000,000	1,000,000
ON ALLOCATION	800,000	600,000	600,000
ON CONFIRMATION	800,000	600,000	600,000
ON START OF WORK	800,000	600,000	600,000
36 MONTHLY INSTALLMENTS (36 x 60,000)	2,160,000	2,160,000	2,160,000
06 HALF YEARLY INSTALLMENTS (6 x 200,000)	1,200,000	1,200,000	1,200,000
PLINTH	750,000	750,000	750,000
SLAB CASTING (13 x 60,000)	780,000	780,000	780,000
BLOCK MASONRY	650,000	675,000	600,000
ON PLASTER	650,000	675,000	600,000
ON COLORING	650,000	675,000	600,000
ON FLOORING	650,000	675,000	600,000
ON FINISHING	650,000	675,000	600,000
ON POSSESSION	560,000	535,000	510,000
CASH PAYABLE	12,100,000	11,600,000	11,200,000

Expected Loan: 8,000,000

Extra Charges:

Corner300,000
West Open300,000
Road Facing300,000
Reserve Car Parking700,000
(Mezzanine Floor Only)

General Car Parking Free

Important Notes:

1. 10% discount on full cash payment and 5% discount on half cash payment at the time of booking.
2. All extra charges will be payable within 180 days from the date of booking.
3. All payments and installments must be paid through payees account by Cheque/Pay Order/Demand Draft in favour of company.
4. Cost of the unit does not include documentation/connection charges which shall be paid by the applicant on demand as per actual.

Name:

Unit No.:

Floor:

Type:

Total Cost:

Booked by:

Date:

Read, Understood & Signed

C.N.I.C. #



TEJORI

HEIGHTS
KARACHI

LAYOUT PLAN

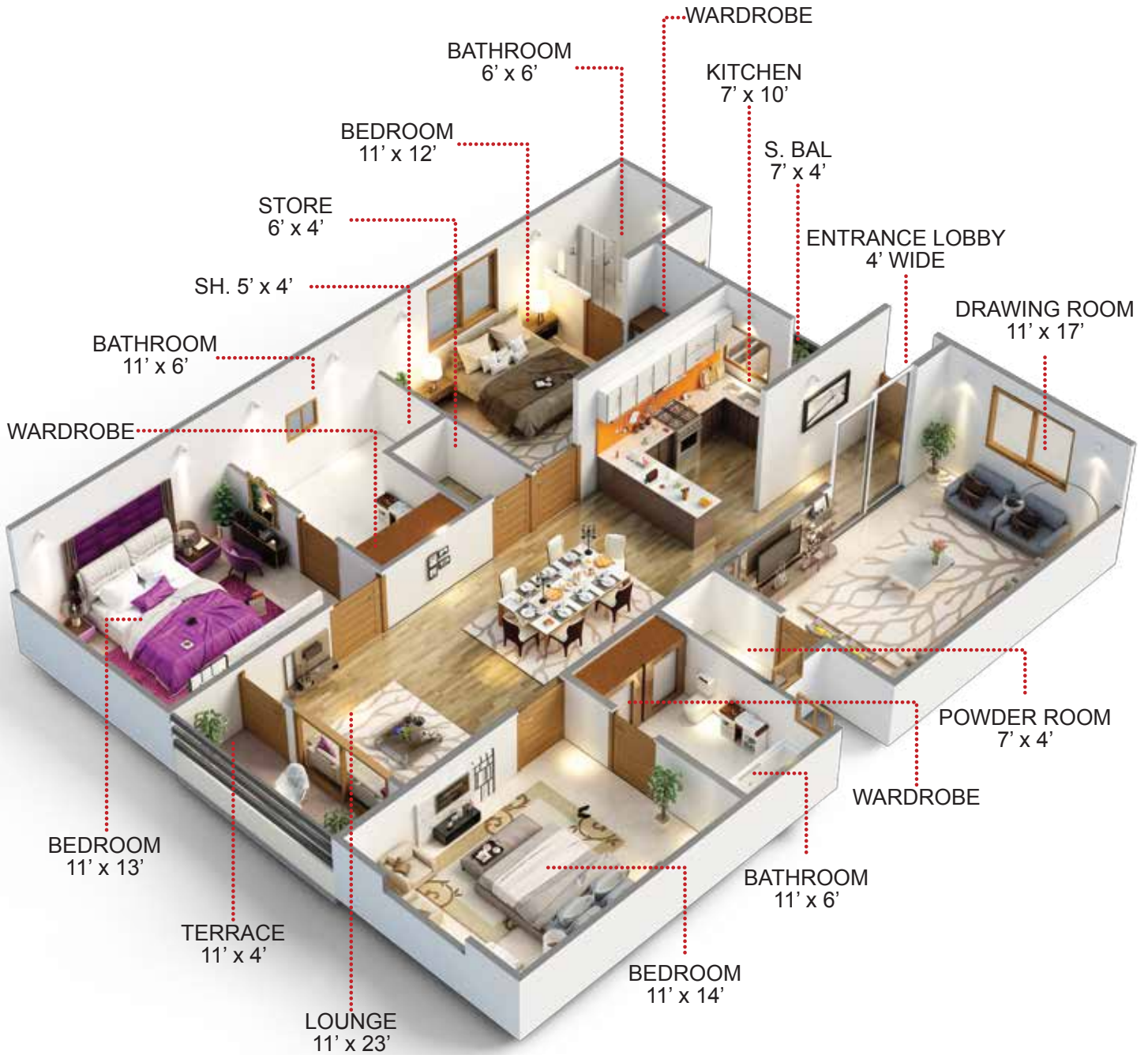

TYPE-A